

## CH-002 CPU HOLDER

### ***Before starting assembly***

- Carefully open the carton, remove contents and lay out on cardboard or other protective surface to avoid damage.
- Check package contents against the Supplied Parts List to assure that all components were received undamaged. Do not use damaged or defective parts.
- Install and operate this device with care. Please read this instruction before beginning the installation, and carefully follow all instructions contained herein. Use proper safety equipment during installation.
- Do not use this product for any purpose or in any configuration not explicitly specified in this instruction. We hereby disclaims any and all liability for injury or damage arising from incorrect assembly, incorrect mounting, or incorrect use of this product.

### ***Supplied Parts List***

01 Holder x1set



05 Caster x4



02 Stopper x4



03 M4X16 Screw x8



04 Cable Tie x2



06 M4X4 x16



### ***Webbing accommodate CPU height in variety:***

- a. CPU width at 80mm maximum height at 650mm.
- b. CPU width at 700mm maximum height at 30mm.

1.Floor

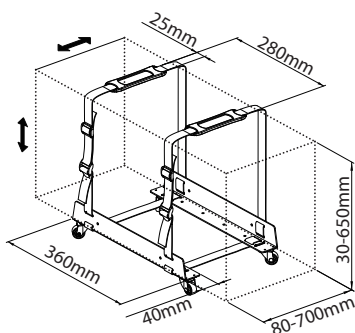

## 2.Under-Desk

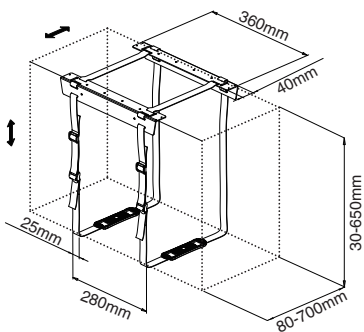

## ASSEMBLY GUIDE—FLOOR

1

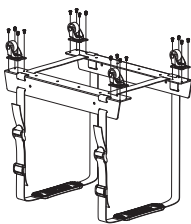

Intall the 4pcs Casters 05 to the Holder 01 by 8pcs M4x4 bolts 06

2

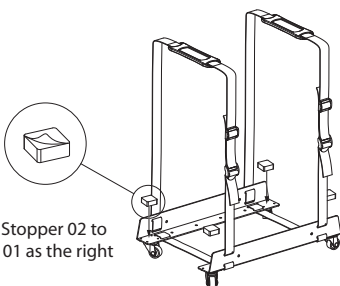

Attach the Stopper 02 to the Holder 01 as the right diagram.

3

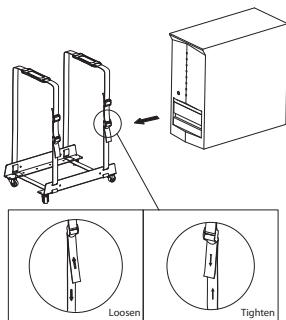

Attach the CPU to the Holder 01 and make sure the base pads placed in the middle of CPU top. Adjust the webbing to fasten the CPU stably on the Holder 01.

4

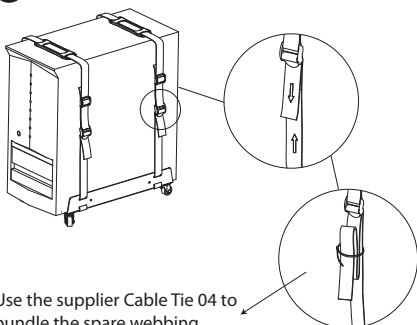

Use the supplier Cable Tie 04 to bundle the spare webbing.

## ASSEMBLY GUIDE—Under-Desk

1

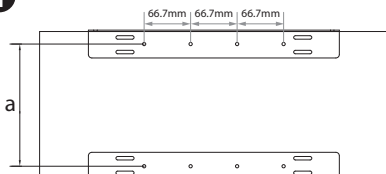

Place Holder 01 on top of CPU as the above diagram. Measure the distance “a” by the tape. Make 8 marks under the desk as the below diagram for the location you want to install this CPU holder.

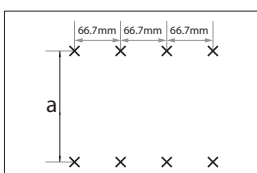

2

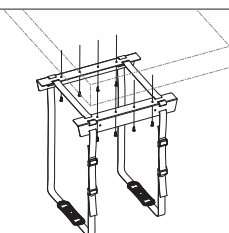

Use 8pcs Screw 03 to fix the Holder 01 under the desk.

3

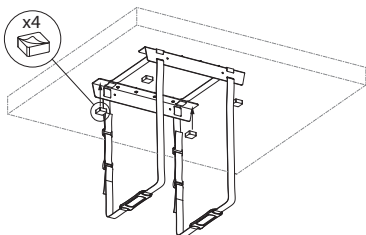

Attach the Stopper 02 to the Holder 01 as the above diagram.

4

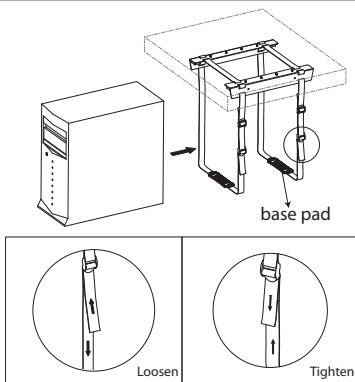

Attach the CPU to the Holder 01 and make sure the base pads placed in the middle of CPU bottom. Adjust the webbing to fasten the CPU stably on the Holder 01.

5

Use the supplier Cable Tie 04 to bundle the spare webbing.

